



THE  
**SPRAY NOZZLE**  
PEOPLE

**MAXIPASS®L**

Low Flow  
Max. Free Passage



## FULL CONE

### DESIGN FEATURES

- ✓ 1/8" and 1/4" connection sizes
- ✓ Ultimate clog-resistant design, with the largest free passage available in an axial, full-cone nozzle
- ✓ Unique, S-shaped internal vanes allow free passage of particles
- ✓ High-energy efficiency
- ✓ Easily handles dirty, contaminated liquids
- ✓ Male connections
- ✓ Nozzle body available in brass, 303 ss and 316 ss
- ✓ Vanes are 316 ss for optimum wear and corrosion resistance

### SPRAY CHARACTERISTICS

- ✓ High reliability spray performance under the most difficult conditions
- ✓ Uniform spray distribution
- ✓ Spray pattern: Full Cone
- ✓ Spray angles: Narrow (N), Medium (M), Wide (W)
- ✓ Flow rates: 0.44 to 7.94 L/min



The MPL nozzle is a low flow rate, full cone nozzle and the ultimate clog-resistant nozzle. It produces uniform spray distribution with a relatively coarse atomisation. The MPL is used in a wide range of applications including:

Parts Cooling  
Deluge Cooling  
Fluid Distribution  
Foam Control  
And many more.

CALL NOW : +44 (0) 1273 400092

[www.spray-nozzle.co.uk](http://www.spray-nozzle.co.uk)

The Go-to People for spray nozzle solutions



Wide(W)

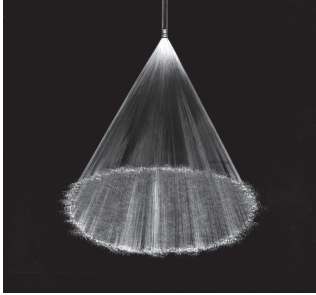

Narrow(N)



Medium(M)



Cutaway view

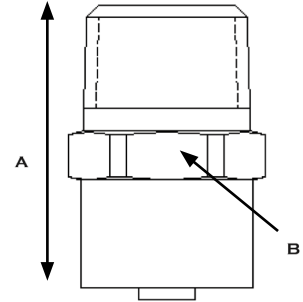

## MPL Spray Angle and Dimensions

## Dimensions and weight

Nozzle No	N spray angle	M spray angle	W spray angle	Approx. Free Passage Dia. (mm)			A	B	Wt (g)			
	3 BAR	3 BAR	3 BAR	N	M	W	Length	Hex Size				
<b>MPL0.21</b>	51	77	129	0.94	0.91	0.91	18	11.1	9			
<b>MPL0.30</b>	53	86	134	1.1	0.99	1.1						
<b>MPL0.42</b>	51	90	128	1.3	1.2	1.1						
<b>MPL0.57</b>	61	92	127	1.5	1.4	1.3						
<b>MPL0.77</b>	62	90	125	1.7	1.7	1.7						
<b>MPL1.12</b>	60	92	124	2.2	2.1	2.1				22	14.3	18
<b>MPL1.51</b>	70	97	123	2.7	2.3	2.3						

$$\text{Flow Rate (l/min)} = K (\text{bar})^{0.43}$$

## MPL Flow Rates

Male Pipe Size	Nozzle Number	K Factor	Litres Per Minute @ BAR						
			0.7 BAR	1 BAR	2 BAR	3 BAR	4 BAR	5 BAR	6 BAR
1/8"	MPL0.21	0.514	0.44	0.51	0.69	0.82	0.93	1.03	1.11
	MPL0.30	0.734	0.63	0.73	0.99	1.18	1.33	1.47	1.59
	MPL0.42	1.03	0.88	1.03	1.39	1.65	1.87	2.06	2.23
	MPL0.57	1.39	1.19	1.39	1.87	2.23	2.52	2.78	3
1/4"	MPL0.77	1.88	1.61	1.88	2.53	3.02	3.41	3.76	4.06
	MPL1.12	2.74	2.35	2.74	3.69	4.39	4.97	5.47	5.92
	MPL1.51	3.69	3.17	3.69	4.97	5.92	6.7	7.37	7.97